

TARGET J10

TARGET is the new structural connecting fitting conceived by Italiana Ferramenta with high fastening capacity, suitable for mounting with wood dowels.

TARGET is an ideal solution for the installation of cabinets in tight spaces.

TARGET provides the possibility of pre-assembling into the panels without obstructing the packaging.

FEATURES AND BENEFITS

Easy pre-assembling

Simple pre-insertion into the panels. Conceived for automatic assembling.

Suitable for furniture in kit

Its unique features make **TARGET** the ideal solution for kit furniture.

No hardware kits

There is no need of hardware kits.

High-speed assembling

Mounting is extremely fast and efficient thanks to the pre-assembling of the panels.

Strong structural fastening

The panels are hard and securely fastened, therefore the cabinet is 100% stress-resistant.

Wide range of applications

Practical solution for a wide range of applications.

15 - 25 mm



INSTALLATION

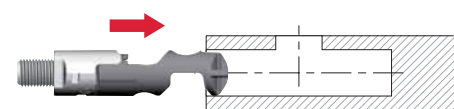

VERY IMPORTANT

Insert **TARGET** connecting with countersunk hole on top.

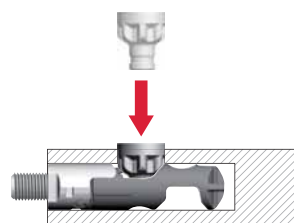
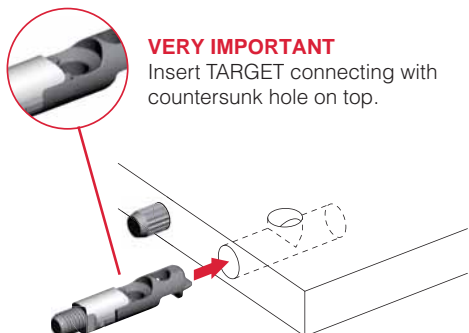

Place the pinion screw from above.

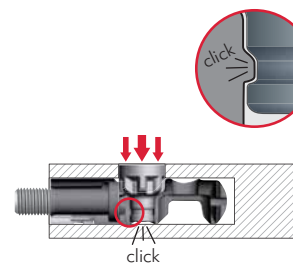
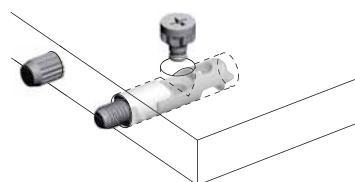

Press strongly with PZ2 cross screwdriver to slot the pinion screw in.

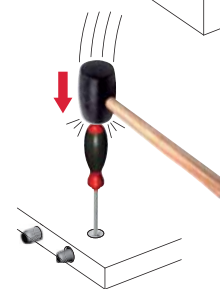
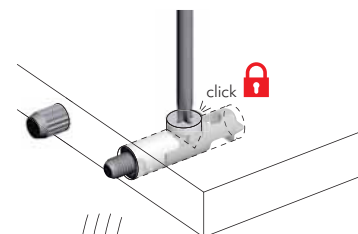

It may be helpful to use a tool in order to easily slot the pinion screw in.

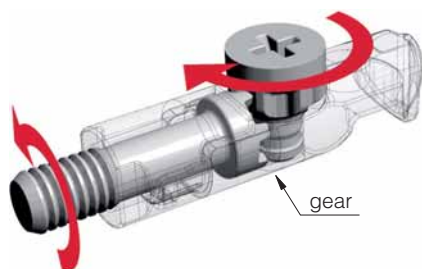

By turning the pinion screw, the threaded dowel makes a synchronized rotation.

ASSEMBLING

VERY IMPORTANT

It is allowed to use a cordless driver drill ONLY with **friction mode** on.

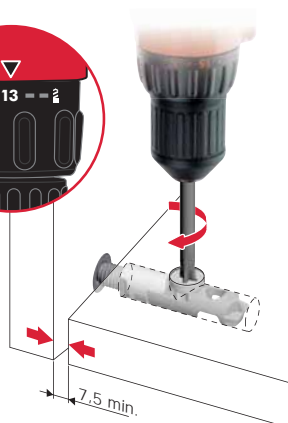
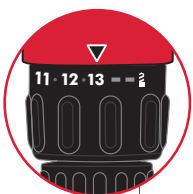

7.5 min.

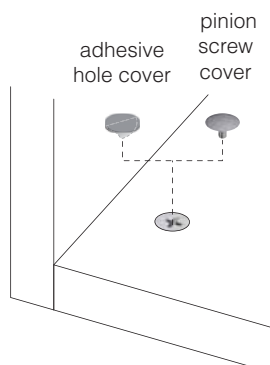

LEVELLER ADJUSTMENT

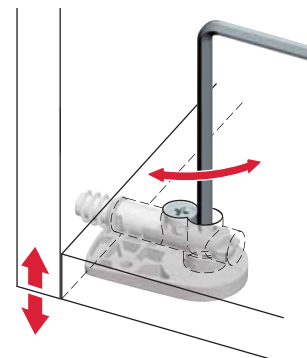

For details refer to the related section about adjustable feet available.